

Project :

Date :

Cat No. :

Type :

Notes :

Volts :

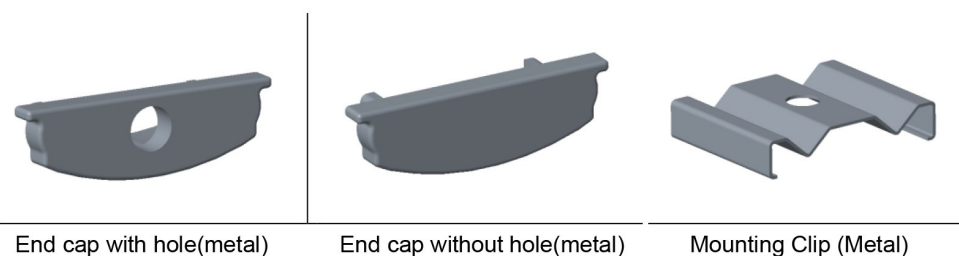
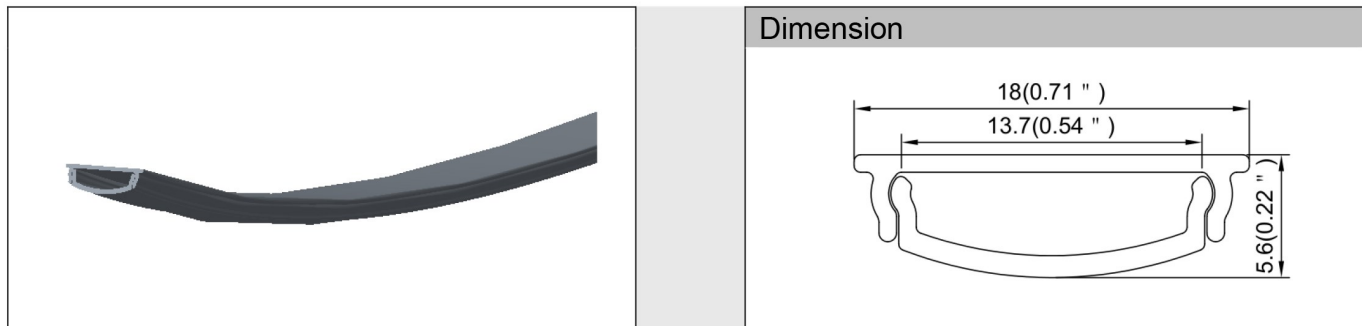

End cap with hole(metal)

End cap without hole(metal)

Mounting Clip (Metal)

Steps of Installation

1. Stick the LED strip



2. Press the cover



3. Insert the end caps



4. Install the clip on the wall



5. Bend the profile to the pattern what you need.



6. Install the profile on the clip



7. Installation completed

