

Project :	Date :
Cat. No. :	Type :
Notes :	Volts :

### Applications:

Ideal for areas where intelligent LED solutions are required.

- For decor, ambiance and public safety.
- Architectural accentuation with warm, natural and cool white.

Suitable for indoor architectural, hospitality, commercial and residential applications.

Look for other LEDIX IP56 rated products for outdoor applications.

### Housing:

Standard

### Source:

0.28W Cool white 5900K 36lumens  
0.42W Warm white 3100K 17 lumens  
0.40W Natural white 4200K 23 lumens

### Finish:

Available in:

- Polished stainless steel finish
- Silver aluminium powder coated
- Graphite powder coated aluminium
- Old gold powder coated aluminium
- White
- Black

### Options:

Choose one of the following

1. Standard (IP44)

### Mounting:

Standard Tico series can be surface mount only.

### Certification :

Conforms to ANSI/UL standard UL-2108  
Certified to CAN/CSA standard 22.2-9.0

### Power supply requirements:

Requires a 12VDC output power supply and can also operate with a 14VDC source for automotive or RV applications.

Leads, connectors and power supply are supplied separately.



04 Standard



05 Standard

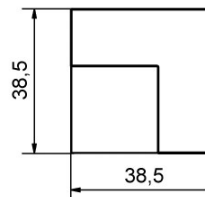
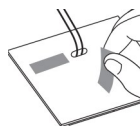

04 Standard

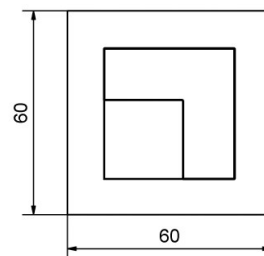

05 Standard



### Ordering Matrix / Specification

Model	Type	Installation	Voltage	Function(s)	Finish color	Color
NTWL			1 (12volts)			
	04= Tico	1- Surface		1- Standard	1- Aluminium	1- Warm
	05= Tico (with square plate)				2- Stainless steel	2- Warm white
					3- Graphite	7- Natural white
					5- White	
					6- Black	

### Natech Industrie

1995 Francis Hughes, Laval, Qc, H7S 2G2: (450) 629-1169, F: (450) 629-1168, [www.natechlighting.com](http://www.natechlighting.com), [service@natechlighting.com](mailto:service@natechlighting.com)

This specification is valid as of 2022-09 and is subject to change without notice. Please confirm with the manufacturer before placing an order.  
Copyright 2014 Natech Industrie. All rights reserved.